

DEAD-LENGTH® COLLET CHUCKS A2-5 TO 5C, 16C AND 3J

Convert Jaw Chuck Lathes
to Collet Spindles for

Precision Turning

Hardinge introduces an all-new A2-5 Dead-Length® Collet Chuck designed to maintain a .001" TIR without the use of tedious adjustment screws. This new engineered design uses fewer parts incorporating Hardinge's world renowned Dead Length® part length control with a non-stick feature to speed up your productivity.

Hardinge HCAC™ Collet Adaptation Chucks offer collet capability to jaw chuck lathes. Benefits include faster job changeover with the use of collets, higher spindle speeds for reduced cycle times, a large work envelope to machine long parts, exact part length control and improved concentricity.

Patent No. US 6,640,679

Renderings shown in color to emphasize components.

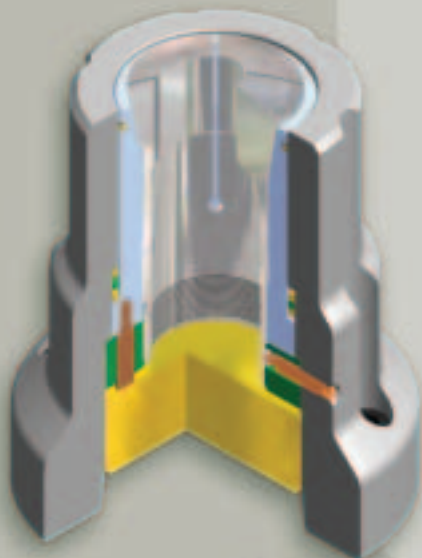

A2-5 Dead-Length[®] Collet Chucks

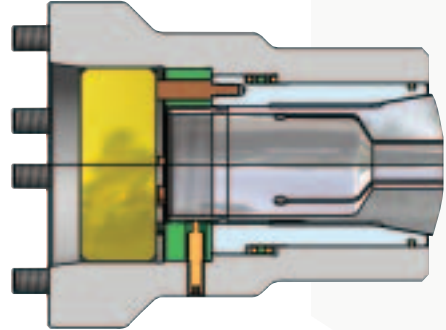
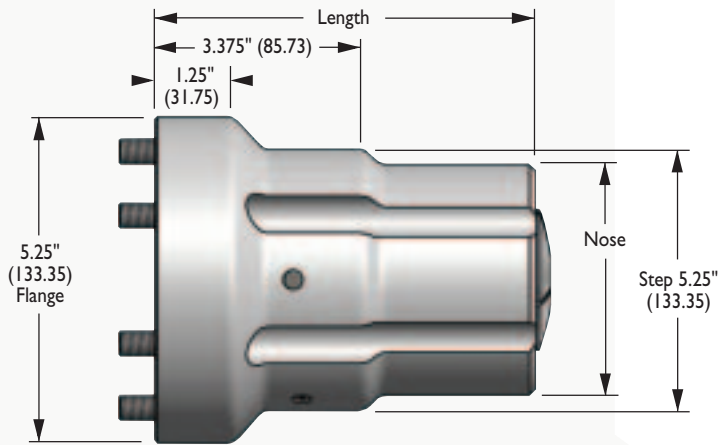

Description	Collet Style	Part No.	Length	Nose
A2-5 to 5C	5C	7803-00-00-000500	5.25" (133.35)	2.50" (63.50)
A2-5 to 16C	16C	7817-00-00-000500	6.125" (155.58)	3.375" (85.73)
A2-5 to 3J	3J	7811-00-00-000500	5.562" (141.27)	3.75" (20.25)

Collet not included. Millimeters in parentheses.

New-design A2-5 Collet Adaptation Chuck from the spindle tooling experts

Exact part length control

.001" TIR maintained

Non-stick feature for increased productivity

Hardinge HCAC™ Collet Adaptation Chucks offer collet capability to jaw chuck lathes. Benefits include faster job changeover with the use of standard draw-in collets, higher spindle speeds for reduced cycle times, large work envelope to machine long workpieces, exact part length control and improved concentricity. Additionally, centrifugal force is not an issue with collet adaptation chucks. Lathes with collet adaptation chucks can safely operate at much higher speeds than jaw chucks. Higher rpm means more pieces per hour.

Linkups can be designed and manufactured by Hardinge or by the customer to fit specific machine requirements.

This new and improved Hardinge Collet Chuck is available for most brand lathes with an A2-5 nose.

Improve accuracy and productivity when and where you need it by using a Hardinge HCAC Collet Adaptation Chuck.

Hardinge Inc. One Hardinge Drive | P.O. Box 1507 | Elmira, New York 14902-1507 USA

USA: 800-843-8801 | Canada: 800-468-5946 | Fax: 607-734-3886

To Order Online: www.hardingetooling.com | Corporate Homepage: www.hardinge.com | E-mail: info@hardingetooling.com